

SATAPro series HDD Enclosure Speedy Data Transfer and Flexible Connectivity



3.5" SATA

● TB-M120
3.5" eSATA / USB 2.0 / FireWire 800



● TD-M120
3.5" eSATA/USB 2.0 /FireWire 400/FireWire 800 with Built-in Fan



● TA-M120
3.5" eSATA/USB 2.0 /FireWire 400



● TB-S120
2.5" USB 2.0/FireWire 400/FireWire 800



● TB-S12T
2.5" eSATA/USB 2.0/FireWire 800



2.5" SATA



● TA-S12T NEW
2.5" eSATA/USB 2.0/FireWire 400

- Supports SATA II and 1.0/1.0a Hard Disk Drives
- Provides connection flexibility with USB 2.0, eSATA and FireWire 400/800 options
- Reduces power consumption via HDD spin down
- Supports Hot-plug and Hot-Swap
- Connects to host by plug-n-play
- Prevents stripping with reinforced screw guides
- Eliminates over-torque with segmented auto-limiting screws
- Resists impact damage to HDD with anti-shock fixing mechanism
- Eliminates driver installation with USB Mass Storage support
- Combines enclosure and FireWire repeater functionality
- Provides an additional FireWire to FireWire 800 cable for greater connection flexibility (TB-M120)

The SATAPro family allows a SATA HDD to be housed in an external enclosure and connected to any computer via the new SATA II (eSATA) connector. The SATAPro family also offers solutions for users that have yet to add eSATA ports, or wish to use an external SATA solution with a notebook computer. Targeted power users and professionals, the SATAPro family equips thermally efficient aluminum housing to maintain optimum temperature for HDD operation, and secure fixing mechanism to protect the HDD against impact damage and accidental drops.

Flexible Connectivity

Innovative SATAPro HDD Enclosures convert internal SATA data signals to USB 2.0 or FireWire 400/800, enabling use of a SATA HDD with any notebook or desktop system with USB or FireWire ports. The DuoLink eSATA/USB 2-in-1 IO connector combines an eSATA and a USB 2.0 port into a single connector to save space and increase flexibility by offering dual interface connectivity in a single port.

Novel Secure Fixing Mechanism of 3.5" SATAPro

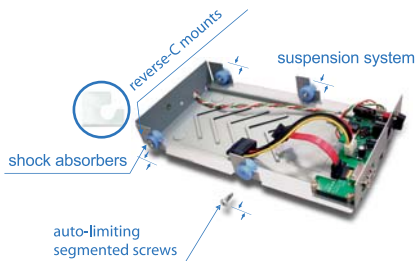

Reduced Power Consumption

The HDD spin down function ensures efficient operation by reducing power consumption. When the host system is powered off, enters sleep mode, or when the SATAPro series HDD is safely removed from the host system, the hard HDD in the enclosure automatically spins down, reducing power consumption.

Advanced Stability and Impact Resistance

The anti-shock chamber and shock absorbers protect the HDD against impact damage and accidental drops, while the secure fixing mechanism maintains HDD stability if the enclosure flips over or encounters violent motion.

Optimized Thermal Protection

The thermally efficient aluminum housing of every SATAPro series HDD enclosure protects valuable data by maintaining optimum HDD temperature.

The TD-M120 SATA HDD enclosure provides a quiet-running, low power fan for high capacity SATA HDDs of 750GB or larger. Heated air is exhausted by vents at the bottom of the 3.5" enclosure housing, providing optimized thermal protection for high RPM SATA hard drives.

Novel Secure Fixing Mechanism of 2.5" SATAPro

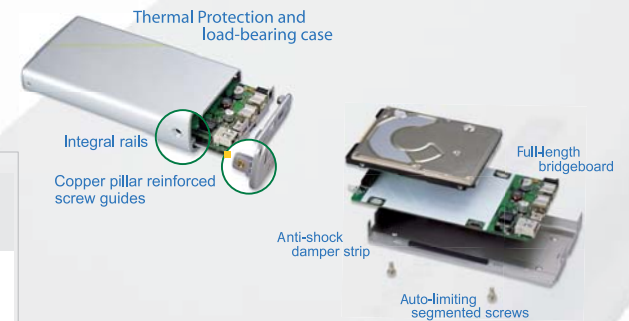

System Requirement

- PC**
- 266MHz or faster CPU (Microsoft Vista requires a minimum 800MHz CPU)
 - 64MB of RAM (Microsoft Vista requires minimum 512MB of RAM)
 - Microsoft Windows 2000, XP, 2003, Vista
 - One available USB 2.0, IEEE 1394a, IEEE 1394b, or eSATA port. (Upon model)
- MAC**
- Macintosh PowerPC or Intel Core Duo processor
 - 64MB of RAM (Mac OS X 10.4 requires 256MB of RAM)
 - Mac OS 9.X or higher (PowerPC/Mac OS X 10.4 (Intel Core Duo))
 - One available USB 2.0, IEEE 1394a, IEEE 1394b, or eSATA port. (Upon model)

Specifications

Model	TB-M120	TA-M120	TB-S120	TB-S12T	TA-S12T
Supported Drive	3.5" SATA hard disk drive		2.5" SATA hard disk drive		
Connector	eSATA x 1 USB mini-B x 1 1394b x 2	eSATA x 1 USB mini-B x 1 1394a x 2	USB mini-B x1 1394a x 1 1394b x 2	USB type B x 1 eSATA x 1 1394b x 2	USB type B x 1 eSATA x 1 1394a x 2
Data Transfer Speed	eSATA: Up to 150Mbps/sec USB: Up to 480 Mbits/sec 1394b: Up to 800 Mbits/sec	eSATA: Up to 3000Mbps/sec USB: Up to 480 Mbits/sec 1394a: Up to 800 Mbits/sec	USB: Up to 480 Mbits/sec 1394a: Up to 400 Mbits/sec 1394b: Up to 800 Mbits/sec	eSATA: Up to 1500 Mbits/sec 1394b: Up to 800 Mbits/sec	eSATA: Up to 3000 Mbits/sec USB: Up to 480 Mbits/sec 1394a: Up to 400 Mbits/sec
Power Supply	12V/3A, 110V~240V, Universal AC Adapter	12V/2A, 15V/2A, 110V~240V, Universal AC Adapter	5V/2A, 110~240V, Universal AC/DC adapter or 1394 Bus power		
Dimension (L x W x H)	226 x 133 x 36 mm (TB-M120) 241 x 133 x 36 mm (TB-M12F)	226 x 133 x 36 mm	129.5 x 80 x 21 mm		
Weight (w/o HDD)	590 g / 620 g		155 g		

Specifications are subjected to change without notice.

