

**TITAN COMPUTER CO.,LTD.**

**13F, No. 111-1, Hsing De Rd., San-Chung City.**

**Taipei Hsien, Taiwan, R.O.C.**

**TEL : 886-2-85122868**

**FAX : 886-2-85123131**

**Web site : <http://www.titan-cd.com>**

**E-mail : [titan@seed.net.tw](mailto:titan@seed.net.tw)**

<b>APPROVAL SHEET</b>
-----------------------

<b>Model</b>	<b>:</b>	<b>TTC-G9TZ</b>
<b>Customer</b>	<b>:</b>	
<b>Revision No.</b>	<b>:</b>	<b>A1</b>
<b>File NO.</b>	<b>:</b>	<b>20091204002</b>
<b>Date</b>	<b>:</b>	<b>2009/12/4</b>
<b>Sales</b>	<b>:</b>	
<b>Source</b>	<b>:</b>	<b>E-mail</b>

<b>CUSTOMER APPROVAL SIGNATURE</b>
------------------------------------



TITAN Technology Limited

TEL:+886(2)85122868 FAX:+886(2)85123131

[www.titan-cd.com](http://www.titan-cd.com)

---

## Contents

● Component List & Drawing	-----	3
● Cooler Assembly Drawing	-----	4
● FAN Parameter & Drawing	-----	5
● SGS Test Report	-----	6~14

• Component List & Drawing

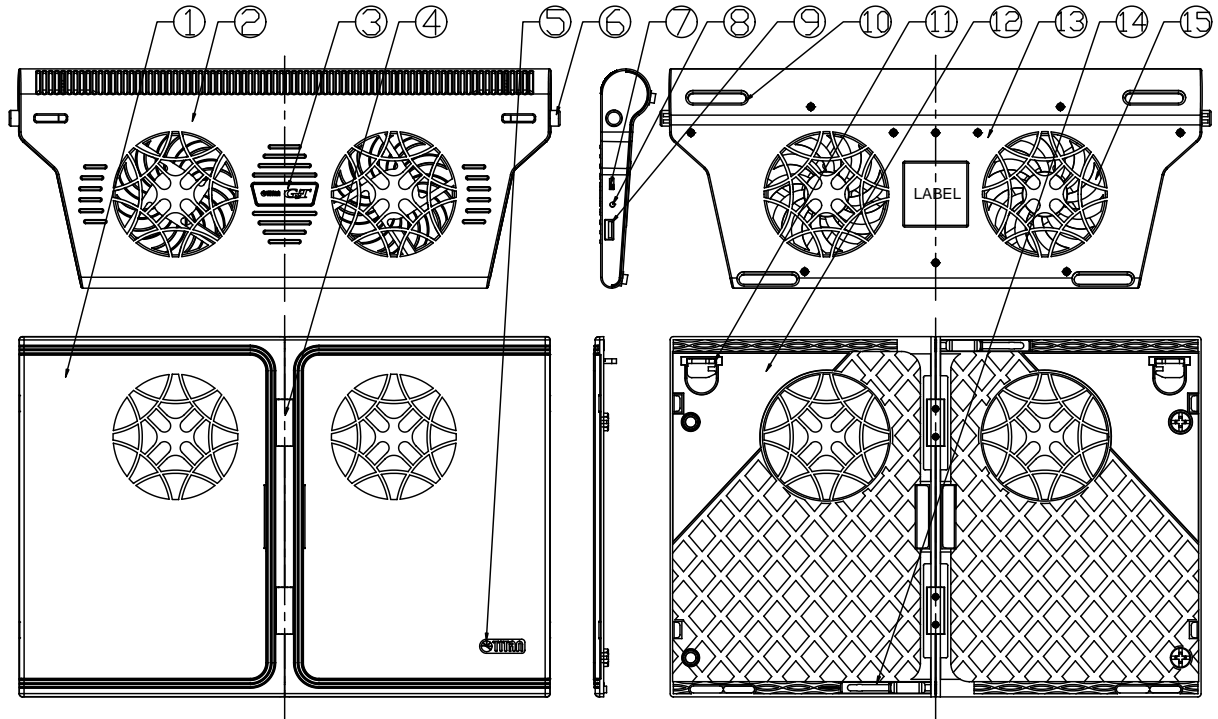

NO.	Part Name	Material	Color	The amount	Note
1	Heat Sink	AL	Silver	2	
2	Top cover	Plastic	Black	1	
3	Nameplate(A)	AL	Silver	1	
4	Clip	AL	Black	4	
5	Nameplate(B)	AL	Silver	1	
6	Push button	Plastic	Black	2	
7	Switch	Plastic	Black	1	
8	LED lamp	Glass	Green	1	
9	USB	Metal	Silver	1	
10	Pad	Rubber	Black	4	
11	Movable bracket	Plastic	Black	2	
12	Panel	Plastic	Black	2	
13	Bottom Cover	Plastic	Black	1	
14	Block slice	SK7	Silver	1	
15	Fan	Plastic	Black	2	

### · Cooler Assembly Drawing

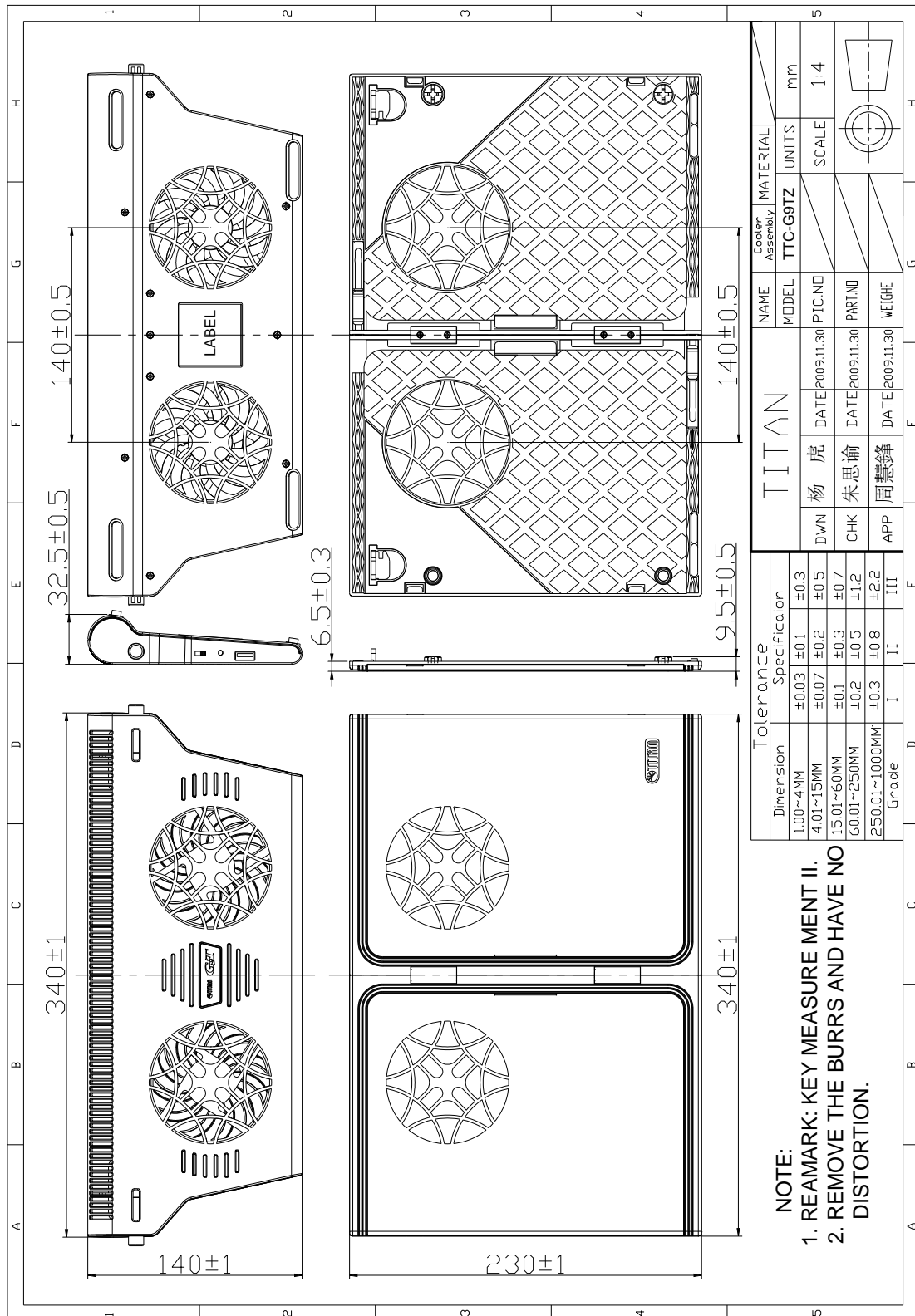

• FAN Parameter & Drawing

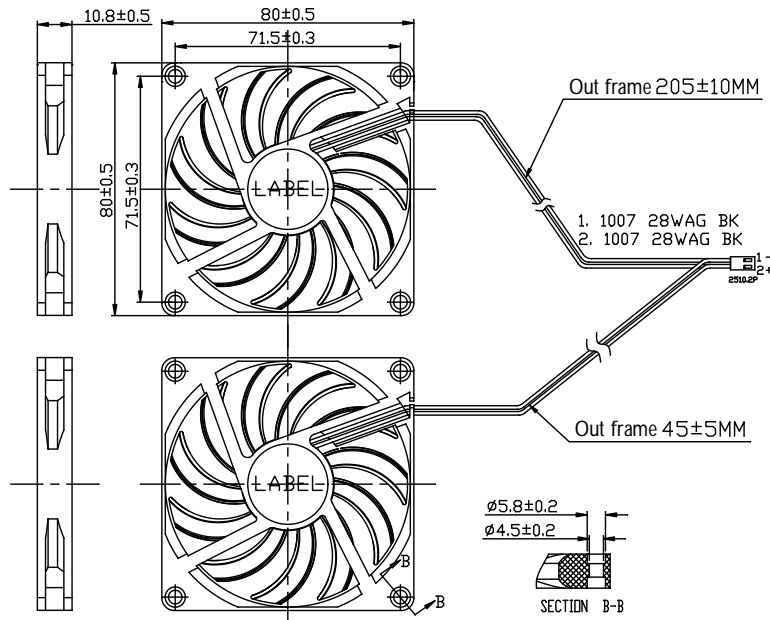

• FAN SPECIFICATION

ITEM		SPECIFICATION/CONDITION
A-1	Part No.	TFD-8010SL05Z*2(only one)
A-2	Outline Dimension	80*80*10 mm
A-3	Rated Voltage	5 VDC
A-4	Rated Current	0.13 A(Max.)
A-5	Power Consumption	0.65 W
A-6	Rated Speed	1500±10%RPM
A-7	Airflow	10.74 CFM(Minimum)
A-8	Static Pressure	0.254 mm-H <sub>2</sub> O(Minimum)
A-9	Noise Level	<20 dBA(Maximum)
A-10	No. of Pole	4 Pole
A-11	Rotation Direction	Counter-Clockwise
A-12	Bearing Type	Z-axis Bearing
A-13	Life Time (Ambient Temp: 25°C)	60,000 Hours

# · SGS Test Report



## Verification Report

No.: GZ0906054533/CHEM

Date: JUL 09, 2009

Page 1 of 9

TITAN TECHNOLOGY LIMITED  
XI-TOU-INDUSTRY PARK, HOU-JIE TOWN, DONGGUAN CITY, GUANGDONG, P.R.CHINA.

Sample Description : DC FAN COOLER  
SGS Ref No. : GZ11930982EC-6.5  
Verification Period : JUN 16, 2009 TO JUL 09, 2009

Verification Requested : With reference to RoHS Directive 2002/95/EC, and its amendment directives

Verification Method

1. Review was performed for the samples disjointed from the submitted articles and the related test reports submitted by the Applicant
2. Tests was performed for the samples indicated by the photos in the report with test methods reference to IEC 62321:2008: Procedures for the Determination of Levels of Six Regulated substances in Electrotechnical Products
  - (1) Screening by XRF Spectroscopy
  - (2) Wet Chemical Test Method
    - a. Determination of Lead by ICP and AAS.
    - b. Determination of Hexavalent Chromium by Colorimetric Method.
    - c. Determination of PBBs and PBDEs by GC/MS.

Verification Results : Please refer to next page

Verification Conclusion : Based on the review of previous reports and verification results of the submitted samples, the results **comply with** the RoHS Directive 2002/95/EC and its subsequent amendments.

Signed for and on behalf of  
SGS-CSTC Ltd.

Shining Deng  
Sr. Engineer

This document is issued by the Company under its General Conditions of Service printed overleaf or available on request and accessible at [http://www.sgs.com/terms\\_and\\_conditions.htm](http://www.sgs.com/terms_and_conditions.htm). Attention is drawn to the limitation of liability, indemnification and jurisdiction issues defined therein. Any holder of this document is advised that information contained herein reflects only the Company's findings at the time of its intervention only and within the limits of Client's instructions, if any. The Company's sole responsibility is to its Client and this document does not generate parties to a transaction from exercising of their rights and obligations under the transaction documents. Any unauthorized alteration, forgery or falsification of the content or appearance of this document is unlawful and offenders may be prosecuted to the fullest extent of the law.  
Unless otherwise stated, the results shown in this test report refer only to the sample(s) tested. This document cannot be reproduced except in full, without prior approval of the Company.



SGS (China) Technology Services Co., Ltd. | 181 Fuzhi Road (South Part) Guangzhou Economic & Technology Development District, Guangzhou, China 510563 | (86-20) 82155555 | (86-20) 82075125 | [www.cn.sgs.com](http://www.cn.sgs.com)  
Singapore SGS (China) Technology Services Co., Ltd. | 中国·广州·经济技术开发区科学城科利路181号 | 邮编: 510563 | (86-20) 82155555 | (86-20) 82075125 | [sgs.china@sgs.com](mailto:sgs.china@sgs.com)

Member of the SGS Group (SGS SA)



**Verification Report**

No.: GZ0906054533/CHEM

Date: JUL 09, 2009

Page 2 of 9

**Details on Verification**

Part No.	Part Name	Restricted Substances	Results of EDXRF <sup>(1)</sup>	No. of Related Test Report	Results in Related Test Report(mg/kg)	Result of Wet Chemical Testing <sup>(2)</sup> (mg/kg)	Conclusion on RoHS	Sample Submitted / Resubmitted Date
1	Silvery metal sheet (radiator)	Cd	BL	\	\	\	Comply	Jun 16, 2009
		Pb	BL				Comply	
		Hg	BL				Comply	
		Cr <sup>2+</sup>	BL				Comply	
		PBBs	---				\	
		PBDEs**	---				\	
2	Black plastic (impeller)	Cd	BL	\	\	\	Comply	Jun 16, 2009
		Pb	BL				Comply	
		Hg	BL				Comply	
		Cr <sup>2+</sup>	BL				Comply	
		PBBs	---				N.D.	
		PBDEs**	IN				Mono-Octa: N.D. Nona:12, Deca:121	
3	Copper-colored metal tube (on No.1)	Cd	BL	\	\	\	Comply	Jun 16, 2009
		Pb	BL				Comply	
		Hg	BL				Comply	
		Cr <sup>2+</sup>	BL				Comply	
		PBBs	---				\	
		PBDEs**	---				\	
4	Brown material (in No.3)	Cd	BL	\	\	\	Comply	Jun 16, 2009
		Pb	BL				Comply	
		Hg	BL				Comply	
		Cr <sup>2+</sup>	BL				Comply	
		PBBs	BL				Comply	
		PBDEs**	---				Comply	
5	Silvery metal block (connected w/ No.3)	Cd	BL	\	\	\	Comply	Jun 16, 2009
		Pb	BL				Comply	
		Hg	BL				Comply	
		Cr <sup>2+</sup>	BL				Comply	
		PBBs	---				\	
		PBDEs**	---				\	
6	Copper-colored metal sheet (on No.5)	Cd	BL	\	\	\	Comply	Jun 16, 2009
		Pb	BL				Comply	
		Hg	BL				Comply	
		Cr <sup>2+</sup>	BL				Comply	
		PBBs	---				\	
		PBDEs**	---				\	
7	Silvery metal sheet (on No.5)	Cd	BL	\	\	\	Comply	Jun 16, 2009
		Pb	BL				Comply	
		Hg	BL				Comply	
		Cr <sup>2+</sup>	BL				Comply	
		PBBs	---				\	
		PBDEs**	---				\	

This document is issued by the Company under its General Conditions of Service printed overleaf or available on request and accessible at [http://www.sgs.com/terms\\_and\\_conditions.htm](http://www.sgs.com/terms_and_conditions.htm). Attention is drawn to the limitation of liability, indemnification and jurisdiction issues defined therein. Any holder of this document is advised that information contained herein reflects the Company's findings at the time of its intervention only and within the limits of Client's instructions, if any. The Company's sole responsibility is to its Client and this document does not generate parties to a transaction from existing all their rights and obligations under the transaction documents. Any unauthorized alteration, forgery or falsification of the content or appearance of this document is unlawful and offenders may be prosecuted to the fullest extent of the law. Unless otherwise stated, the results shown in this test report refer only to the sample(s) tested. This document cannot be reproduced except in full, without prior approval of the Company.



SGS (Singapore) Technology Co., Ltd. | 11th Floor, Radisson Blu Hotel, Singapore Science & Technology Development District, Singapore, China 510563 | (86-20) 82155555 | (85-20) 82075125 | [www.cn.sgs.com](http://www.cn.sgs.com)  
 Singapore Testing Services (Private) Limited | 中国·广州·经济技术开发区科学城科珠路198号 | 邮编: 510661 | (86-20) 82155555 | (85-20) 82075125 | [sgs.china@sgs.com](mailto:sgs.china@sgs.com)

Member of the SGS Group (SGS SA)



Verification Report

No.: GZ0906054533/CHEM

Date: JUL 09, 2009

Page 3 of 9

Part No.	Part Name	Restricted Substances	Results of EDXRF <sup>(1)</sup>	No. of Related Test Report	Results in Related Test Report(mg/kg)	Result of Wet Chemical Testing <sup>(2)</sup> (mg/kg)	Conclusion on RoHS	Sample Submitted / Resubmitted Date
8	Silvery metal screw (on No.7)	Cd	BL	\	\	\	Comply	Jun 16, 2009
		Pb	BL		\	\	Comply	
		Hg	BL		\	\	Comply	
		Cr <sup>VI</sup>	BL		\	\	Comply	
		PBBs	---		\	\	Comply	
PBDEs <sup>3F</sup>	---	\	\	Comply				
9	Translucent plastic (on No.7)	Cd	BL	\	\	\	Comply	Jun 16, 2009
		Pb	BL		\	\	Comply	
		Hg	BL		\	\	Comply	
		Cr <sup>VI</sup>	BL		\	\	Comply	
		PBBs	IN		\	N.D.	Comply	
PBDEs <sup>3F</sup>	---	\	N.D.	Comply				
10	Black plastic tube (on No.9)	Cd	BL	\	\	\	Comply	Jun 16, 2009
		Pb	BL		\	\	Comply	
		Hg	BL		\	\	Comply	
		Cr <sup>VI</sup>	BL		\	\	Comply	
		PBBs	IN		\	N.D.	Comply	
PBDEs <sup>3F</sup>	---	\	N.D.	Comply				
11-C	Golden metal screw (on No.5)	Cd	BL	\	\	\	Comply	Jun 16, 2009/ Jun 30, 2009
		Pb	IN		\	20207 (See remark <sup>(1)</sup> )	Comply	
		Hg	BL		\	\	Comply	
		Cr <sup>VI</sup>	BL		\	\	Comply	
		PBBs	---		\	\	Comply	
PBDEs <sup>3F</sup>	---	\	\	Comply				
12	White adhesive plastic w/ black printing (label on No.2)	Cd	BL	\	\	\	Comply	Jun 16, 2009
		Pb	BL		\	\	Comply	
		Hg	BL		\	\	Comply	
		Cr <sup>VI</sup>	BL		\	\	Comply	
		PBBs	BL		\	\	Comply	
PBDEs <sup>3F</sup>	---	\	\	Comply				
13	Silvery metal clip (on No.1)	Cd	BL	\	\	\	Comply	Jun 16, 2009
		Pb	BL		\	\	Comply	
		Hg	BL		\	\	Comply	
		Cr <sup>VI</sup>	IN		\	Negative	Comply	
		PBBs	---		\	\	Comply	
PBDEs <sup>3F</sup>	---	\	\	Comply				
14	Transparent rubber (on No.13)	Cd	BL	\	\	\	Comply	Jun 16, 2009
		Pb	BL		\	\	Comply	
		Hg	BL		\	\	Comply	
		Cr <sup>VI</sup>	BL		\	\	Comply	
		PBBs	---		\	\	Comply	
PBDEs <sup>3F</sup>	---	\	\	Comply				

This document is issued by the Company under its General Conditions of Service printed overleaf or available on request and accessible at [http://www.sgs.com/terms\\_and\\_conditions.htm](http://www.sgs.com/terms_and_conditions.htm). Attention is drawn to the limitation of liability, indemnification and jurisdiction issues defined therein. Any holder of this document is advised that information contained herein reflects only the findings at the time of its intervention only and within the limits of Client's instructions, if any. The Company's sole responsibility is to its Client and this document does not generate parties to a transaction from absolving all their rights and obligations under the transaction documents. Any unauthorized alteration, forgery or falsification of the content or appearance of this document is unlawful and offenders may be prosecuted to the fullest extent of the law. All references to the results shown in this test report refer only to the sample(s) tested. This document cannot be reproduced except in full, without prior approval of the Company.



SGS (Singapore) Pte. Ltd. | 100 Beach Road, Singapore 189701 | Tel: (65-20) 8215555 | Fax: (65-20) 82075125 | www.cn.sgs.com  
 SGS (China) Co., Ltd. | 中国·广州·经济技术开发区科学城科韵路198号 | 邮编: 510663 | Tel: (86-20) 82155555 | Fax: (86-20) 82075125 | e: sgs.china@sgs.com

Member of the SGS Group (SGS SA)





Verification Report

No.: GZ0906054533/CHEM

Date: JUL 09, 2009

Page 4 of 9

Part No.	Part Name	Restricted Substances	Results of EDXRF <sup>(1)</sup>	No. of Related Test Report	Results in Related Test Report(mg/kg)	Result of Wet Chemical Testing <sup>(2)</sup> (mg/kg)	Conclusion on RoHS	Sample Submitted / Resubmitted Date
15	Purple adhesive plastic w/ black printing (label on No.2)	Cd	BL	\	\	\	Comply	Jun 16, 2009
		Pb	BL		\	\	Comply	
		Hg	BL		\	\	Comply	
		Cr <sup>VI</sup>	BL		\	\	Comply	
		PBBs PBDEs <sup>**</sup>	BL		\	\	Comply	
16	Blue plastic (wire insulation) (connected w/ No.2)	Cd	BL	\	\	\	Comply	Jun 16, 2009
		Pb	BL		\	\	Comply	
		Hg	BL		\	\	Comply	
		Cr <sup>VI</sup>	BL		\	\	Comply	
		PBBs PBDEs <sup>**</sup>	BL		\	\	Comply	
17	Red plastic (wire insulation) (connected w/ No.2)	Cd	BL	\	\	\	Comply	Jun 16, 2009
		Pb	BL		\	\	Comply	
		Hg	BL		\	\	Comply	
		Cr <sup>VI</sup>	BL		\	\	Comply	
		PBBs PBDEs <sup>**</sup>	BL		\	\	Comply	
18	Black plastic (wire insulation) (connected w/ No.2)	Cd	BL	\	\	\	Comply	Jun 16, 2009
		Pb	BL		\	\	Comply	
		Hg	BL		\	\	Comply	
		Cr <sup>VI</sup>	BL		\	\	Comply	
		PBBs PBDEs <sup>**</sup>	BL		\	\	Comply	
19	Silvery metal wire (in No.18)	Cd	BL	\	\	\	Comply	Jun 16, 2009
		Pb	BL		\	\	Comply	
		Hg	BL		\	\	Comply	
		Cr <sup>VI</sup>	BL		\	\	Comply	
		PBBs PBDEs <sup>**</sup>	---		\	\	Comply	
20	White adhesive plastic w/ multicolor printing (on No.18)	Cd	BL	\	\	\	Comply	Jun 16, 2009
		Pb	BL		\	\	Comply	
		Hg	BL		\	\	Comply	
		Cr <sup>VI</sup>	BL		\	\	Comply	
		PBBs PBDEs <sup>**</sup>	BL		\	\	Comply	
21	Beige plastic shell (connected w/ No.18)	Cd	BL	\	\	\	Comply	Jun 16, 2009
		Pb	BL		\	\	Comply	
		Hg	BL		\	\	Comply	
		Cr <sup>VI</sup>	BL		\	\	Comply	
		PBBs PBDEs <sup>**</sup>	BL		\	\	Comply	

This document is issued by the Company under its General Conditions of Service printed overleaf or available on request and accessible at [http://www.sgs.com/terms\\_and\\_conditions.htm](http://www.sgs.com/terms_and_conditions.htm). Attention is drawn to the limitation of liability, indemnification and jurisdiction issues defined therein. Any holder of this document is advised that information contained herein reflects only the Company's findings at the time of its intervention only and within the limits of Client's instructions, if any. The Company's sole responsibility is to its Client and this document does not generate parties to a transaction from exercising all their rights and obligations under the transaction documents. Any unauthorized alteration, forgery or falsification of the content or appearance of this document is unlawful and offenders may be prosecuted to the fullest extent of the law. Unless otherwise stated, the results shown in this test report refer only to the sample(s) tested. This document cannot be reproduced except in full, without prior approval of the Company.



SGS (Singapore) Technology Co., Ltd. | 新加坡分公司 | 新加坡 | 100000 | (65-20) 8215555 | (65-20) 8207525 | [www.cn.sgs.com](http://www.cn.sgs.com)  
 Singapore SGS Chemical Laboratory | 中国·广州·经济技术开发区科学城科珠路198号 | 邮编: 510663 | (86-20) 8215555 | (86-20) 8207525 | [sgs.dina@sgs.com](mailto:sgs.dina@sgs.com)

Member of the SGS Group (SGS SA)



Verification Report

No.: GZ0906054533/CHEM

Date: JUL 09, 2009

Page 5 of 9

Part No.	Part Name	Restricted Substances	Results of EDXRF <sup>(1)</sup>	No. of Related Test Report	Results in Related Test Report(mg/kg)	Result of Wet Chemical Testing <sup>(2)</sup> (mg/kg)	Conclusion on RoHS	Sample Submitted / Resubmitted Date
22	Silvery metal terminal (in No.21)	Cd	BL	\	\	\	Comply	Jun 16, 2009
		Pb	BL		\	\	Comply	
		Hg	BL		\	\	Comply	
		Cr <sup>VI</sup>	BL		\	\	Comply	
		PBBs	---		\	\	\	
		PBDEs <sup>SP</sup>	---		\	\	\	
23	Black rubber cap (on No.2)	Cd	BL	\	\	\	Comply	Jun 16, 2009
		Pb	BL		\	\	Comply	
		Hg	BL		\	\	Comply	
		Cr <sup>VI</sup>	BL		\	\	Comply	
		PBBs	BL		\	\	Comply	
		PBDEs <sup>SP</sup>	BL		\	\	Comply	
24	Green "PCB"	Cd	BL	\	\	\	Comply	Jun 16, 2009
		Pb	BL		\	\	Comply	
		Hg	BL		\	\	Comply	
		Cr <sup>VI</sup>	BL		\	\	Comply	
		PBBs	IN		\	N.D.	Comply	
		PBDEs <sup>SP</sup>	IN		\	N.D.	Comply	
25	Silvery metal (solder on No.24)	Cd	BL	\	\	\	Comply	Jun 16, 2009
		Pb	BL		\	\	Comply	
		Hg	BL		\	\	Comply	
		Cr <sup>VI</sup>	BL		\	\	Comply	
		PBBs	---		\	\	\	
		PBDEs <sup>SP</sup>	---		\	\	\	
26-C	Yellow glue (on No.24)	Cd	BL	\	\	\	Comply	Jun 16, 2009/ Jun 30, 2009
		Pb	BL		\	\	Comply	
		Hg	BL		\	\	Comply	
		Cr <sup>VI</sup>	BL		\	\	Comply	
		PBBs	BL		\	\	Comply	
		PBDEs <sup>SP</sup>	BL		\	\	Comply	
27-C	Black body w/ silvery printing (on No.24)	Cd	BL	\	\	\	Comply	Jun 16, 2009/ Jun 30, 2009
		Pb	BL		\	\	Comply	
		Hg	BL		\	\	Comply	
		Cr <sup>VI</sup>	BL		\	\	Comply	
		PBBs	IN		\	N.D.	Comply	
		PBDEs <sup>SP</sup>	IN		\	N.D.	Comply	
28-C	Black body w/ brown printing (on No.24)	Cd	BL	\	\	\	Comply	Jun 16, 2009/ Jun 30, 2009
		Pb	BL		\	\	Comply	
		Hg	BL		\	\	Comply	
		Cr <sup>VI</sup>	BL		\	\	Comply	
		PBBs	IN		\	N.D.	Comply	
		PBDEs <sup>SP</sup>	IN		\	N.D.	Comply	

This document is issued by the Company under its General Conditions of Service printed overleaf or available on request and accessible at [http://www.sgs.com/terms\\_and\\_conditions.htm](http://www.sgs.com/terms_and_conditions.htm). Attention is drawn to the limitation of liability, indemnification and jurisdiction issues defined therein. Any holder of this document is advised that information contained herein reflects only the Company's findings at the time of its intervention only and within the limits of Client's instructions, if any. The Company's sole responsibility is to its Client and this document does not generate parties to a transaction from exercising all their rights and obligations under the transaction documents. Any unauthorized alteration, forgery or falsification of the content or appearance of this document is unlawful and offenders may be prosecuted to the fullest extent of the law.



SGS (Singapore) Technology Co., Ltd. | 新加坡分公司 | 新加坡 | 100000 | 85-20 82075125 | [www.cn.sgs.com](http://www.cn.sgs.com)  
 SGS (China) Technology Co., Ltd. | 中国·广州·经济技术开发区科学城科珠路198号 | 邮编: 510663 | 86-20 82155555 | 85-20 82075125 | [sgs.china@sgs.com](mailto:sgs.china@sgs.com)

Member of the SGS Group (SGS SA)



Verification Report

No.: GZ0906054533/CHEM

Date: JUL 09, 2009

Page 6 of 9

Part No.	Part Name	Restricted Substances	Results of EDXRF <sup>(1)</sup>	No. of Related Test Report	Results in Related Test Report(mg/kg)	Result of Wet Chemical Testing <sup>(2)</sup> (mg/kg)	Conclusion on RoHS	Sample Submitted / Resubmitted Date	
29	Lt-blue plated metal shell	Cd	BL	1	\	\	Comply	Jun 16, 2009	
		Pb	BL				Comply		
		Hg	BL				Comply		
		Cr <sup>VI</sup>	IN				Negative		Comply
		PBBs	---				\		Comply
PBDEs <sup>**</sup>	---	\	Comply						
30	Dk-grey core (magnet) (in No.29)	Cd	BL	1	\	\	Comply	Jun 16, 2009	
		Pb	BL				Comply		
		Hg	BL				Comply		
		Cr <sup>VI</sup>	BL				\		Comply
		PBBs	BL				\		Comply
PBDEs <sup>**</sup>	---	\	Comply						
31	Silvery metal (silicon steel sheet) (in No.29)	Cd	BL	1	\	\	Comply	Jun 16, 2009	
		Pb	BL				Comply		
		Hg	BL				Comply		
		Cr <sup>VI</sup>	IN				Negative		Comply
		PBBs	---				\		Comply
PBDEs <sup>**</sup>	---	\	Comply						
32	Black plastic (on No.31)	Cd	BL	1	\	\	Comply	Jun 16, 2009	
		Pb	BL				Comply		
		Hg	BL				Comply		
		Cr <sup>VI</sup>	BL				\		Comply
		PBBs	---				N.D.		Comply
PBDEs <sup>**</sup>	IN	Mono-Hepta: N.D. Octa:10, Nona:37, Deca:79	Comply						
33	Red surfaced metal wire (on No.31)	Cd	BL	1	\	\	Comply	Jun 16, 2009	
		Pb	BL				Comply		
		Hg	BL				Comply		
		Cr <sup>VI</sup>	BL				\		Comply
		PBBs	BL				\		Comply
PBDEs <sup>**</sup>	---	\	Comply						
34	Silvery metal shaft (in No.31)	Cd	BL	1	\	\	Comply	Jun 16, 2009	
		Pb	BL				Comply		
		Hg	BL				Comply		
		Cr <sup>VI</sup>	IN				Negative		Comply
		PBBs	---				\		Comply
PBDEs <sup>**</sup>	---	\	Comply						
35	White plastic ring (on No.34)	Cd	BL	1	\	\	Comply	Jun 16, 2009	
		Pb	BL				Comply		
		Hg	BL				Comply		
		Cr <sup>VI</sup>	BL				\		Comply
		PBBs	BL				\		Comply
PBDEs <sup>**</sup>	---	\	Comply						

This document is issued by the Company under its General Conditions of Service printed overleaf or available on request and accessible at [http://www.sgs.com/terms\\_and\\_conditions.htm](http://www.sgs.com/terms_and_conditions.htm). Attention is drawn to the limitation of liability, indemnification and jurisdiction issues defined therein. Any holder of this document is advised that information contained herein reflects the Company's findings at the time of its intervention only and within the limits of Client's instructions, if any. The Company's sole responsibility is to its Client and this document does not generate parties to a transaction from exercising all their rights and obligations under the transaction documents. Any unauthorized alteration, forgery or falsification of the content or appearance of this document is unlawful and offenders may be prosecuted to the fullest extent of the law.



SGS (Singapore) Technical Services Co., Ltd. | 11th Floor, Road & Tech Park, Singapore Science & Technology Development District, Singapore, China 510563 | (86-20) 82155555 | (85-20) 82075125 | www.cn.sgs.com  
 中国·广州·经济技术开发区科学城科珠路1105号 邮编: 510963 | (86-20) 82155265 | (85-20) 82075125 | e.sgs.china@sgs.com

Member of the SGS Group (SGS SA)



Verification Report

No.: GZ0906054533/CHEM

Date: JUL 09, 2009

Page 7 of 9

Part No.	Part Name	Restricted Substances	Results of EDXRF <sup>(1)</sup>	No. of Related Test Report	Results in Related Test Report(mg/kg)	Result of Wet Chemical Testing <sup>(2)</sup> (mg/kg)	Conclusion on RoHS	Sample Submitted / Resubmitted Date
36	Red rubber ring (on No.34)	Cd	BL	\	\	\	Comply	Jun 16, 2009
		Pb	BL		\	\	Comply	
		Hg	BL		\	\	Comply	
		Cr <sup>VI</sup>	BL		\	\	Comply	
		PBBs	BL		\	\	Comply	
		PBDEs <sup>RP</sup>	BL		\	\	Comply	
37	Copper-colored metal tube (on No.34)	Cd	BL	\	\	\	Comply	Jun 16, 2009
		Pb	BL		\	\	Comply	
		Hg	BL		\	\	Comply	
		Cr <sup>VI</sup>	BL		\	\	Comply	
		PBBs	---		\	\		
		PBDEs <sup>RP</sup>	---		\	\		
38	Black rubber ring (on No.37)	Cd	BL	\	\	\	Comply	Jun 16, 2009
		Pb	BL		\	\	Comply	
		Hg	BL		\	\	Comply	
		Cr <sup>VI</sup>	BL		\	\	Comply	
		PBBs	BL		\	\	Comply	
		PBDEs <sup>RP</sup>	BL		\	\	Comply	
39	Green rubber ring (on No.37)	Cd	BL	\	\	\	Comply	Jun 16, 2009
		Pb	BL		\	\	Comply	
		Hg	BL		\	\	Comply	
		Cr <sup>VI</sup>	BL		\	\	Comply	
		PBBs	BL		\	\	Comply	
		PBDEs <sup>RP</sup>	BL		\	\	Comply	
40	Silvery metal cap (on No.37)	Cd	BL	\	\	\	Comply	Jun 16, 2009
		Pb	BL		\	\	Comply	
		Hg	BL		\	\	Comply	
		Cr <sup>VI</sup>	BL		\	\	Comply	
		PBBs	---		\	\		
		PBDEs <sup>RP</sup>	---		\	\		
41	Transparent plastic washer (in No.40)	Cd	BL	\	\	\	Comply	Jun 16, 2009
		Pb	BL		\	\	Comply	
		Hg	BL		\	\	Comply	
		Cr <sup>VI</sup>	BL		\	\	Comply	
		PBBs	BL		\	\	Comply	
		PBDEs <sup>RP</sup>	BL		\	\	Comply	
42	White paste	Cd	BL	\	\	\	Comply	Jun 16, 2009
		Pb	BL		\	\	Comply	
		Hg	BL		\	\	Comply	
		Cr <sup>VI</sup>	BL		\	\	Comply	
		PBBs	BL		\	\	Comply	
		PBDEs <sup>RP</sup>	BL		\	\	Comply	

This document is issued by the Company under its General Conditions of Service printed overleaf or available on request and accessible at [http://www.sgs.com/terms\\_and\\_conditions.htm](http://www.sgs.com/terms_and_conditions.htm). Attention is drawn to the limitation of liability, indemnification and jurisdiction issues defined therein. Any holder of this document is advised that information contained herein reflects only the Company's findings of the time of its intervention only and within the limits of Client's instructions, if any. The Company's sole responsibility is to its Client and this document does not, in any way, constitute part of a transaction from existing or future clients and obligators under the transaction documents. Any unauthorized alteration, forgery or falsification of the content or appearance of this document is unlawful and offenders may be prosecuted to the fullest extent of the law. Unless otherwise stated, the results shown in this test report refer only to the sample(s) tested. This document cannot be reproduced except in full, without prior approval of the Company.



SGS (Singapore) Technology Services Co., Ltd.  
Singapore Chemical Laboratory

111 Kuch Road (located at Guangzhou Science City) District, Guangzhou, China 510663 | (86-20) 82155555 | (86-20) 82075125 | [www.cn.sgs.com](http://www.cn.sgs.com)  
中国·广州·经济技术开发区科学城科韵路198号 邮编: 510663 | (86-20) 82155555 | (86-20) 82075125 | [sgs.china@sgs.com](mailto:sgs.china@sgs.com)

Member of the SGS Group (SGS SA)



**Verification Report**

No.: GZ0906054533/CHEM

Date: JUL 09, 2009

Page 8 of 9

Part No.	Part Name	Restricted Substances	Results of EDXRF <sup>(1)</sup>	No. of Related Test Report	Results in Related Test Report(mg/kg)	Result of Wet Chemical Testing <sup>(2)</sup> (mg/kg)	Conclusion on RoHS	Sample Submitted / Resubmitted Date
43	Silvery adhesive plastic w/ multicolor printing (label on No.2)	Cd	BL	1	1	1	Comply	Jun 16, 2009
		Pb	BL		1	1	Comply	
		Hg	BL		1	1	Comply	
		Cr <sup>VI</sup>	BL		1	1	Comply	
		PBBs	BL		1	1	Comply	
		PBDEs <sup>RP</sup>			1	1	Comply	
44	Silvery adhesive plastic w/ multicolor printing (label on No.2)	Cd	BL	1	1	1	Comply	Jun 16, 2009
		Pb	BL		1	1	Comply	
		Hg	BL		1	1	Comply	
		Cr <sup>VI</sup>	BL		1	1	Comply	
		PBBs	BL		1	1	Comply	
		PBDEs <sup>RP</sup>			1	1	Comply	

This document is issued by the Company under its General Conditions of Service printed overleaf or available on request and accessible at [http://www.sgs.com/terms\\_and\\_conditions.htm](http://www.sgs.com/terms_and_conditions.htm). Attention is drawn to the limitation of liability, indemnification and jurisdiction issues defined therein. Any holder of this document is advised that information contained herein reflects the Company's findings at the time of its intervention only and within the limits of Client's instructions, if any. The Company's sole responsibility is to its Client and this document does not generate parties to a transaction from exercising all their rights and obligations under the transaction documents. Any unauthorized alteration, forgery or falsification of the content or appearance of this document is unlawful and offenders may be prosecuted to the fullest extent of the law. If any other information is shown in this test report refer only to the sample(s) tested. This document cannot be reproduced except in full, without prior approval of the Company.



SGS (Singapore) Technical Services Co., Ltd. | 新加坡分公司 | 新加坡 | 510563 | (65-20) 8215555 | (65-20) 82075125 | [www.cn.sgs.com](http://www.cn.sgs.com)  
 Singapore Technical Services Laboratory | 中国·广州·经济技术开发区科学城科珠路198号 | 邮编: 510663 | (86-20) 82155555 | (86-20) 82075125 | [sgs.china@sgs.com](mailto:sgs.china@sgs.com)

Member of the SGS Group (SGS SA)

